

Stainless steel conveyor system XMX

System information



Chain width 83 mm



Features

- Wide range of wet applications
- Wedge conveyors
- High speed solutions
- Many chain types available from the standard XM range
- Higher capacity than XL

Examples of application areas

Filling lines within the food, personal products and liquid pharmaceuticals segments.

Technical characteristics

Drive unit capacity	1250 N
Chain tension limit	1250 N
Beam width	85 mm
Chain width	83 mm
Item width	20–200 mm
Maximum item weight	
Horizontal transport	15 kg
Vertical transport.....	10 kg
Maximum weight on conveyor.....	200 kg
Maximum conveyor length	30 m

PO
XS
XL
XLP
X85
X85P
XH
XK
XKP
XB
GR
CS
XT
XC
XF
FST
XMY
XLX
XM
GRX
CSX
ELV
CTL
TR
APX
IDX

Conveyor beam XMx

Conveyor beam

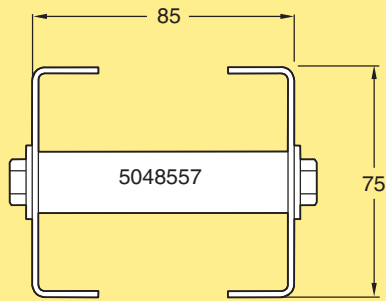

Beam
 Length 3 m
 Length to order (0,2–3,0 m) **XMCBx 3**
XMCBx L

Beam section for chain installation

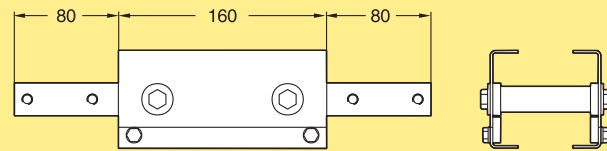

Beam section for chain installation **XMCCx 160**
 Including connecting strips
 Screws and nuts for the connecting strips are not included

Beam accessories XMx

Connecting strip

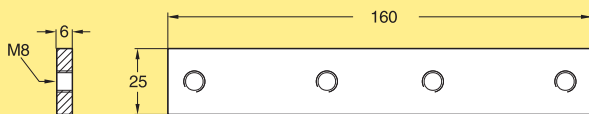

Connecting strip **XLCJx 6x160**
 Mounting: M6S 8x12 A4 (4), BRB 8,4x24 A4 (4)
 Screws and nuts are not included

Slide rails XMx

Plastic slide rail for XL, X85, XMx, XH beam



Slide rail
 Length 25 m
 Polyethylene (PE) (Grey) **XLCR 25**
 PVDF (Transparent white) **XLCR 25 P**
 UHMW-PE (White) **XLCR 25 U**
 PA-PE (Grey) **XLCR 25 H**

See Appendix A, page 351 for selection guidelines and assembly instructions.

Stainless steel rivet

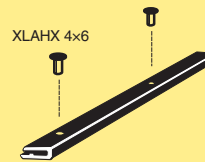

Stainless steel rivet, 4 mm **XLAHX 4x6**
 Note. Must be ordered in multiples of 50

Plastic screw for slide rail

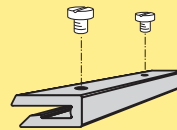

Plastic screw 5 mm for XL-XMx-XH **XLAG 5**
 Note. Must be ordered in multiples of 50

Mounting tool for slide rail

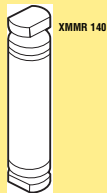

Mounting tool XMx **XMMR 140**

Drill fixture for slide rail

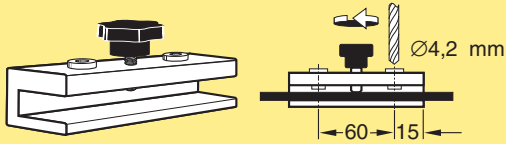

Drill fixture for slide rail

3920500

Rivet crimping clamp for XL-X85/XM-XH

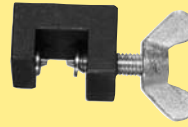

Rivet crimping clamp
For 4 mm rivets

3923005

Rivet crimping pliers for XL-X85/XM-XH



Rivet crimping pliers
For 4 mm rivets

5051395

End drive units XMX

End drive unit HLP

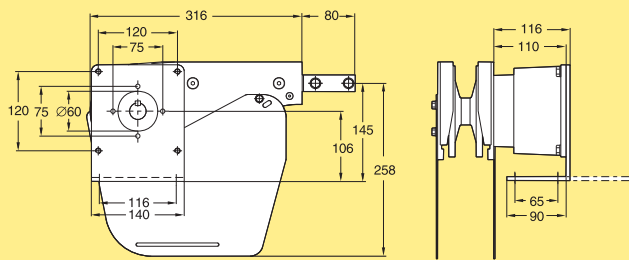

End drive unit (without motor)
Transmission on left side

XMEBX 0 HLP

Effective track length: 0,80 m

End drive unit HRP

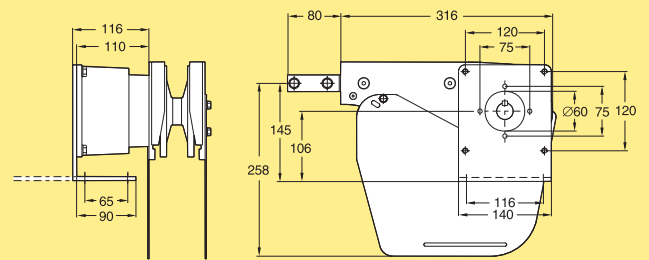

End drive unit (without motor)
Transmission on right side

XMEBX 0 HRP

Effective track length: 0,80 m

Drive unit shaft kit

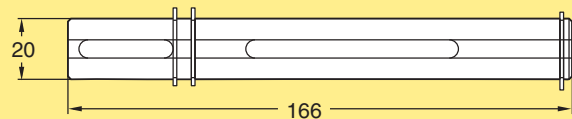

Drive unit shaft kit for stainless
steel drive units Series X

5051185

*For SEW SA37 gearbox. Including the necessary
mounting hardware*

Idler end unit XMJ

Idler end unit

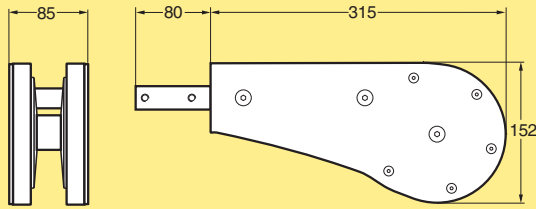

Idler end unit

XMEJX 315

Effective track length: 0,80 m

Wheel bends XMJ

Wheel bend, 30°

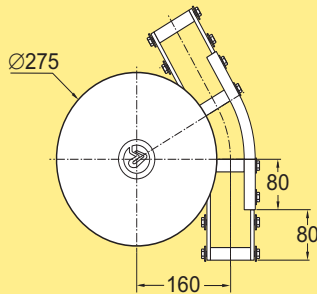

Wheel bend, 30°

XMBHX 30R160

Effective track length: 0,25 m (2-way 0,50 m)

Wheel bend, 180°

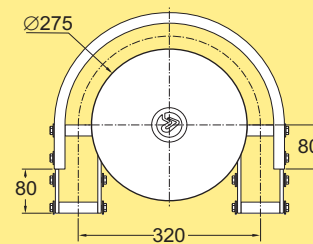

Wheel bend, 180°

XMBHX 180R160

Effective track length: 0,65 m (2-way 1,30 m)

Wheel bend, 45°

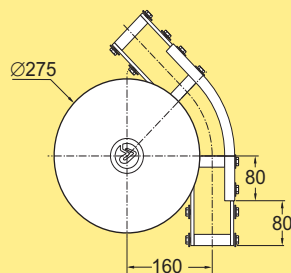

Wheel bend, 45°

XMBHX 45R160

Effective track length: 0,30 m (2-way 0,60 m)

Safety cover for wheel bend XMBHX

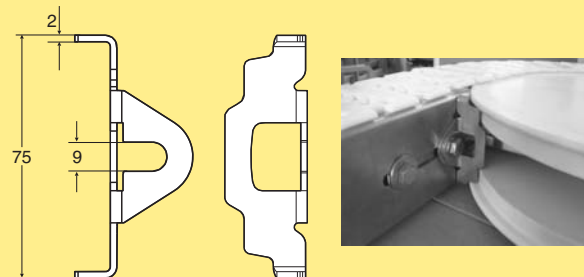

Safety cover for wheel bend XMBHX **5056996**

Each item consists of two (2) covers.

Use the existing screw and washer for assembly.

Wheel bend, 90°

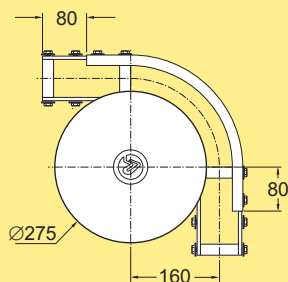

Wheel bend, 90°

XMBHX 90R160

Effective track length: 0,40 m (2-way 0,80 m)

Horizontal plain bends XMX

Horizontal plain bend, 90°

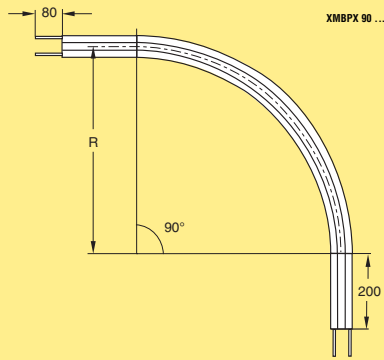

Horizontal plain bend, 90°

R=500
R=1000

XMBPX 90R500
XMBPX 90R1000

Effective track lengths:

R500: 1,20 m (2-way: 2,40 m)

R1000: 2,00 m (2-way: 3,95 m)

Note

Other angles and radii are available on request.

Vertical bends XMX

Vertical bend 5°

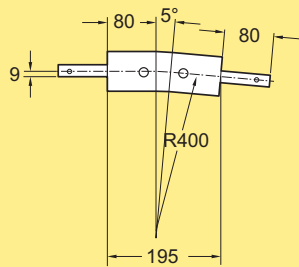

Vertical bend, 5°

XMBVX 5R400

Effective track length: 0,20 m 1-way (0,40 m 2-way)

Vertical bend 15°

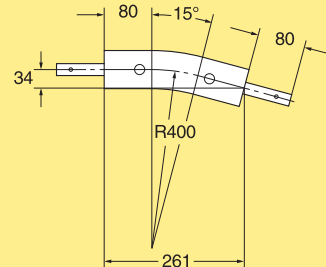

Vertical bend, 15°

XMBVX 15R400

Effective track length: 0,30 m 1-way (0,55 m 2-way)

Note

Other angles and radii are available on request.

