

Stainless steel conveyor system XLX

System information



Chain width 63 mm



Features

- Wide range of wet applications
- Wedge conveyors
- High speed solutions
- Many chain types available from the standard XL range

Examples of application areas

Filling lines within the food, personal products and liquid pharmaceuticals segments.

Technical characteristics

Drive unit capacity	500 N
Chain tension limit	500 N
Beam width	65 mm
Chain width	63 mm
Item width	15–140 mm
Maximum item weight	
Horizontal transport	10 kg
Vertical transport.....	2 kg
Maximum weight on conveyor.....	150 kg
Maximum conveyor length	40 m

PO
XS
XL
XLP
X85
X85P
XH
XK
XKP
XB
GR
CS
XT
XC
XF
FST
XMY
XLX
XMX
GRX
CSX
ELV
CTL
TR
APX
IDX

Beam XLX

Conveyor beam

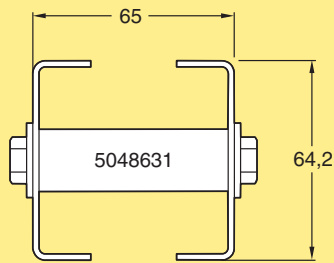

Beam

Length 3 m

Length to order (0,2–3,0 m)

XLCBX 3
XLCBX L

Beam section for chain installation

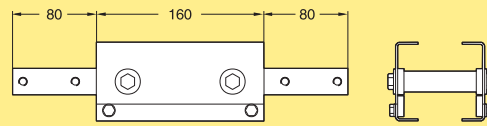

Beam section for chain installation **XLCCX 160**

Including connecting strips

Screws and nuts for the connecting strips are not included

Beam accessories XLX

Connecting strip



Connecting strip

XLCJX 6x160

Mounting: M6S 8x12 A4 (4), BRB 8,4x24 A4 (4)
Screws and nuts are not included

Slide rails XLX

Plastic slide rail for XL, X85, XH beam

XLCR 25 P/H



XLCR 25 U



Slide rail

Length 25 mm

Polyethylene (PE) (Grey)

PVDF (Transparent white)

UHMW-PE (White)

PA-PE (Grey)

XLCR 25
XLCR 25 P
XLCR 25 U
XLCR 25 H

Installation of slide rails

See installation instructions in Appendix A, page 351, or in the separate Conveyor assembly manual.

Drill fixture for slide rail

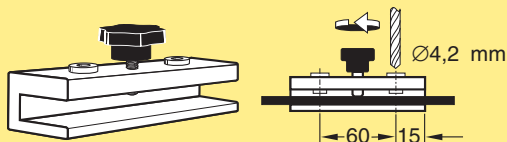

Drill fixture for slide rail

3920500

Plastic screw for slide rail

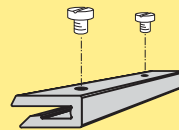

Plastic screw 5 mm for XL-X85-XH **XLAG 5**

Note. Must be ordered in multiples of 50

Stainless steel rivet

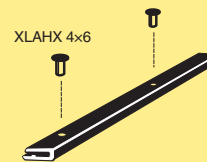

Stainless steel rivet, 4 mm

XLAHX 4x6

Note. Must be ordered in multiples of 50

Rivet crimping pliers for XL-X85-XH



Rivet crimping pliers
For 4 mm rivets

5051395

Mounting tool for slide rail

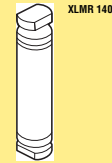

Mounting tool XL

XLMR 140

Rivet crimping clamp for XL-X85-XH

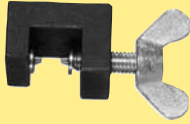

Rivet crimping clamp
For 4 mm rivets

3923005

End drive units XLX

End drive unit HLP

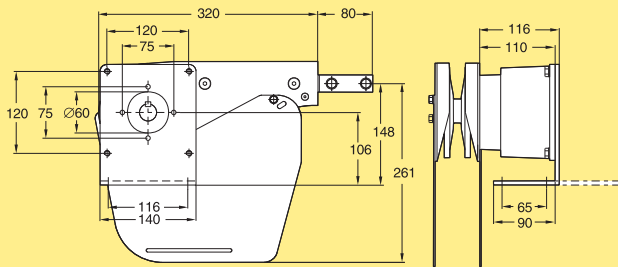

End drive unit (without motor)
Transmission on left side

XLEBX 0 HLP

Effective track length: 0,80 m

End drive unit HRP

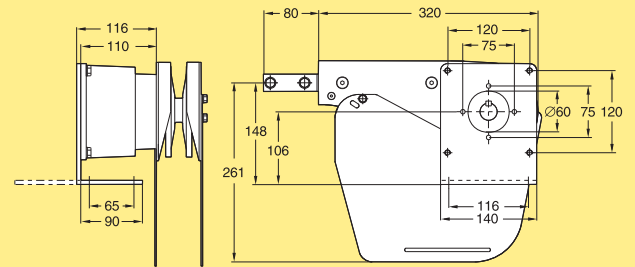

End drive unit (without motor)
Transmission on right side

XLEBX 0 HRP

Effective track length: 0,80 m

Drive unit shaft kit

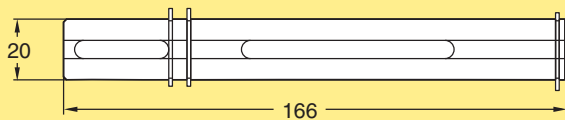

Drive unit shaft kit for stainless
steel drive units Series X

5051185

*For SEW SA37 gearbox. Including the necessary
mounting hardware*

PO
XS
XL
XLP
X85
X85P
XH
XK
XKP
XB
GR
CS
XT
XC
XF
FST
XMY
XLX
XMX
GRX
CSX
ELV
CTL
TR
APX
IDX

Idler end unit XLX

Idler end unit

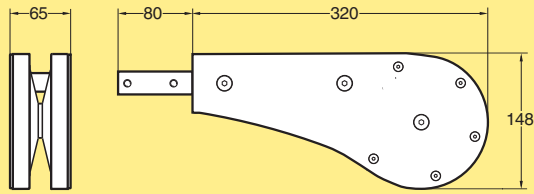

Idler end unit

XLEJX 320

Effective track length: 0,80 m

Wheel bends XLX

Wheel bend, 30°

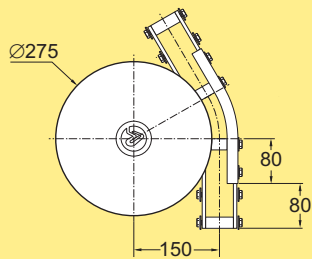

Wheel bend, 30°

XLBHX 30R150

Effective track length: 0,25 m (2-way 0,50 m)

Wheel bend, 90°

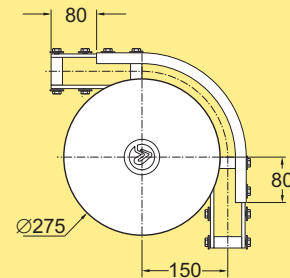

Wheel bend, 90°

XLBHX 90R150

Effective track length: 0,40 m (2-way 0,80 m)

Wheel bend, 45°

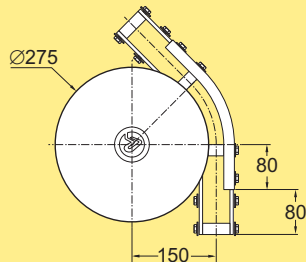

Wheel bend, 45°

XLBHX 45R150

Effective track length: 0,30 m (2-way 0,60 m)

Wheel bend, 180°

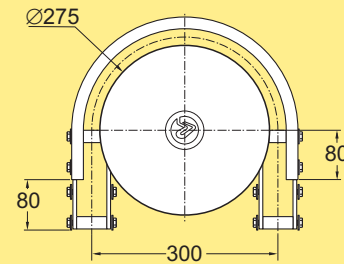

Wheel bend, 180°

XLBHX 180R150

Effective track length: 0,65 m (2-way 1,30 m)

Safety cover for wheel bend XLBHX

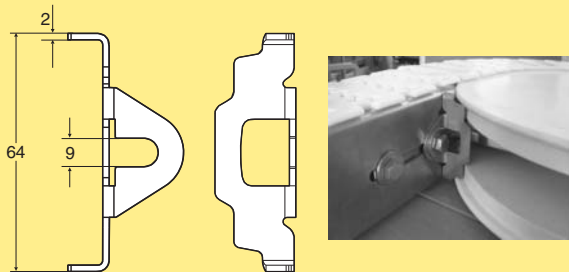

Safety cover for wheel bend XLBHX **5056997**

Each item consists of two (2) covers 5056925.
Use the existing screw and washer for assembly.

Horizontal plain bends XLX

Horizontal plain bend, 90°

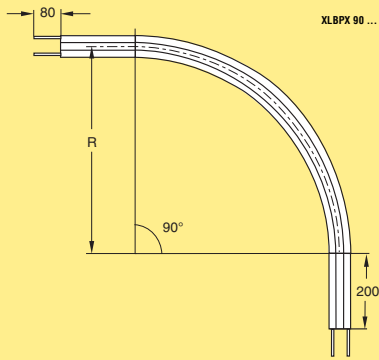

Horizontal plain bend, 90°

R=500
R=1000

XLBPX 90R500
XLBPX 90R1000

Effective track lengths:

R500: 1,20 m (2-way: 2,40 m)

R1000: 2,00 m (2-way: 3,95 m)

Note

Other angles and radii are available on request.

Vertical bends XLX

Vertical bend 5°

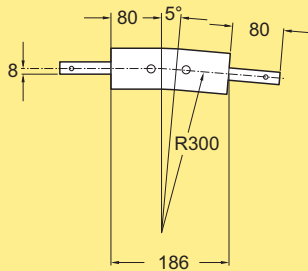

Vertical bend, 5°

XLBVX 5R300

Effective track length: 0,20 m 1-way (0,40 m 2-way)

Vertical bend 15°

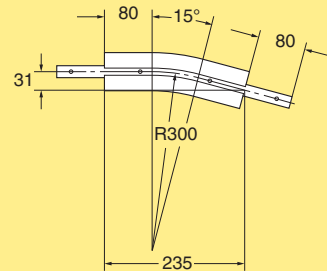

Vertical bend, 15°

XLBVX 15R300

Effective track length: 0,25 m 1-way (0,50 m 2-way)

Note

Other angles and radii are available on request.

PO
XS
XL
XLP
X85
X85P
XH
XK
XKP
XB
GR
CS
XT
XC
XF
FST
XMY
XLX
XMX
GRX
CSX
ELV
CTL
TR
APX
IDX

