

Conveyor system XB

System information

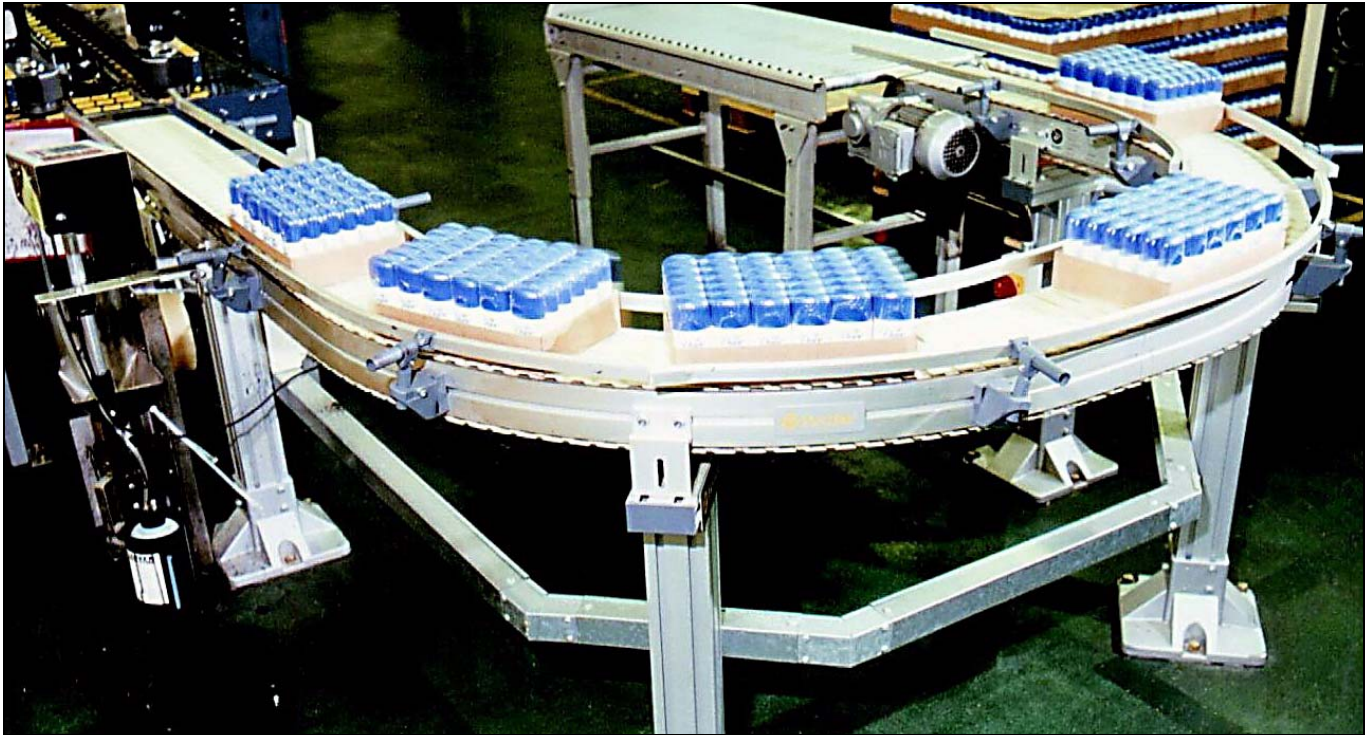

Chain width 175/295 mm

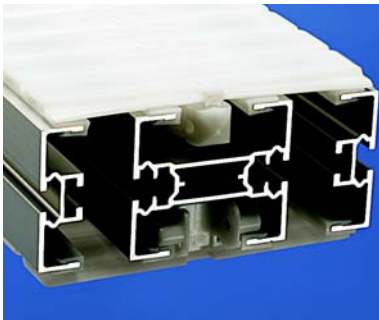

Maximum item weight 15 kg
Maximum weight on conveyor 200 kg
Maximum conveyor length 30 m

Features

Chain travels on four slide rails. Wide track sideflexing safety chain. Compact horizontal and vertical bends. Suitable for soft packages.

Examples of application areas

Large cardboard boxes, products in soft plastic bags. Examples: detergent powder, wrapped tissue paper rolls, food products, personal care products.

Technical characteristics

Drive unit capacity 1250 N
Chain tension limit 1250 N
Beam width 182/300 mm
Chain width 175/295 mm
Chain pitch 33,5 mm
Item width 70–400 mm

PO
XS
XL
XLP
X85
X85P
XH
XK
XKP
XB
GR
CS
XT
XC
XF
FST
XMY
XLX
XMX
GRX
CSX
ELV
CTL
TR
APX
IDX

Chains XB

Plain chain 175 mm

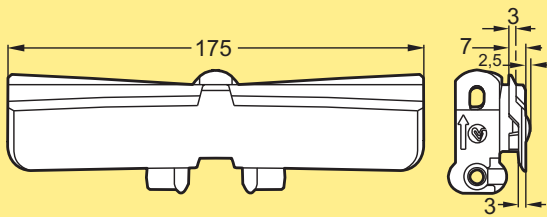

Plain chain
Length 3 m

XBTP 3A175

Plain link kit *

5056651

* Link kit contains 10 links, 10 pivots, 10 steel pins

Friction top chain 295 mm

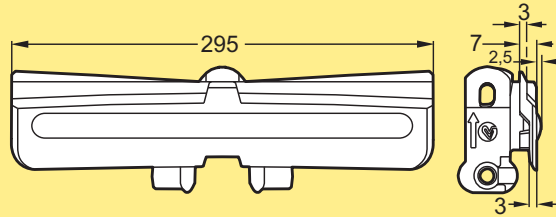

Friction top chain
Length 3 m

XBTP 3A295 F#

Enter cleat frequency (1–10) instead of # in product designation.

Friction top link kit
Kit with 10 links *

5054874

*Note. Links are delivered as a kit containing 10 links and the necessary steel pins and plastic pivots.

Friction top chain 175 mm

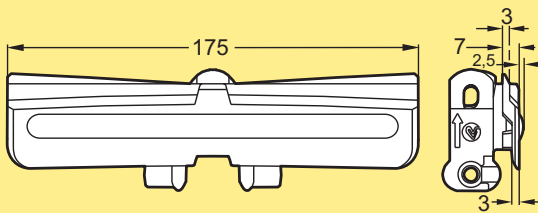

Friction top chain
Length 3 m

XBTP 3A175 F#

Enter cleat frequency (1–20) instead of # in product designation.

Friction top link kit *

5056653

* Link kit contains 10 links, 10 pivots, 10 steel pins

Other chains

See the *FlexLink chain guide* for a selection of other chains.

Chain installation

See Appendix C, page 361, for installation instructions.

Roller cleat link 175 mm

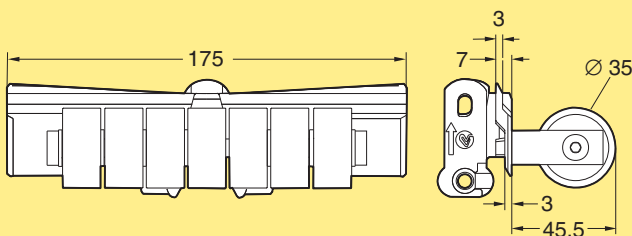

Roller cleat link

XBTL 175x46 R

Roller cleat chain must be ordered as plain chain plus desired number of roller cleat links. Cannot be ordered as chain

Plain chain 295 mm

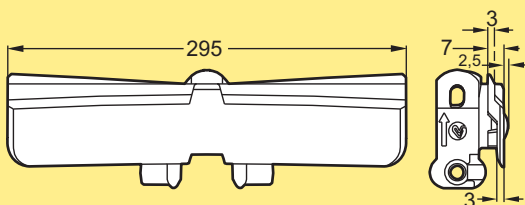

Plain chain
Length 3 m

XBTP 3A295

Plain link kit *

5056652

* Link kit contains 10 links, 10 pivots, 10 steel pins

Chain accessories XB

Plastic pivot

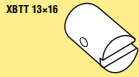

Plastic pivot XB kit

5111169

Each kit contains 25 items.

Steel pin

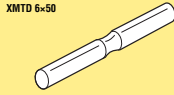

Steel pin XB kit

5111172

Each kit contains 25 items.

Pin insertion tool for chain

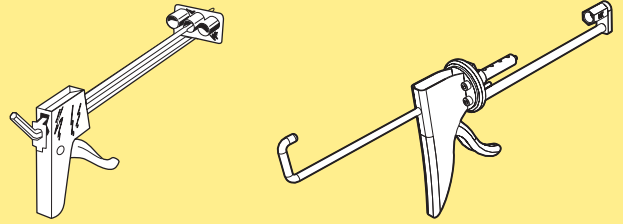

Pin insertion tool

X85-XB

X85-XB-XH, PRO version*

XMMJ 6

XBMJ 6 P

*This tool is recommended for frequent users

Lubricant for chain



Silicone-based lubricant

LDSS 450

Beam components XB

Beam section (182 mm version)

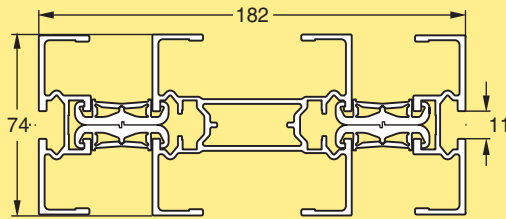

Beam section (assembled)

Length 3 m

Length to order (0,5–3 m)

XBCB 3A175

XBCB LA175

Slide rail: see page 171

Beam (mid-section)

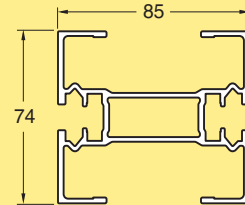

Beam (mid-section)

Length 3 m (3030 ±5 mm)

Length to order (30- 3000 mm)

XBCB 3A85

XBCB LA85

Beam section kit (300 mm version)

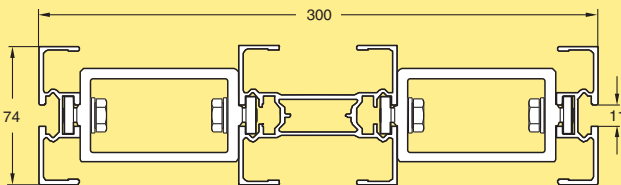

Beam section kit

Length 3 m

Length to order (0,5–3 m)

XBCB 3A295

XBCB LA295

The beam section is delivered unassembled.

Slide rail: see page 171

Beam (outer section)

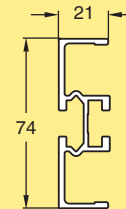

Beam (outer section)

Length 3 m (3030 ±5 mm)

Length to order (30- 3000 mm)

XBCB 3A H

XBCB LA H

Beam components XB (continued)

Profile for split conveyor beam (inner section)

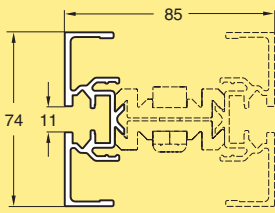

Profile for split conveyor beam
Length 3 m (3030 ±5 mm)
Length to order (30- 3000 mm)

XBCB 3A85 H
XBCB LA85 H

Beam clip assembly

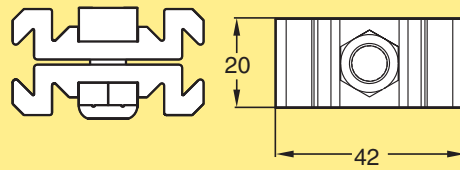

Beam clip assembly

XBCE 42x20

Including M8 screw and locking nut. Use minimum 5 clips per meter. Place clips 100 mm from each end. Note. Must be ordered in multiples of 10.

Clip kit for outer beam sections

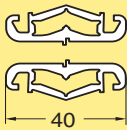

Snap-fit clip kit for outer beam sections

XBCE 40

Each kit contains two clips. For construction of 182 mm wide beam sections. Mounting tool: see below. Maximum distance between clips is 0,5 m.

Mounting tool for clip kit

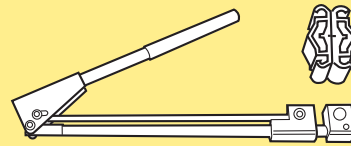

Mounting tool for aluminium clip kit
XBCE 40

3923518

Spacer for outer beam sections

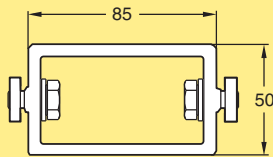

Spacer, aluminium, one pair

XBCE 85

Including screws and nuts. For construction of 300 mm wide beam sections. Maximum distance between spacers is 0,5 m.

Beam section for chain installation

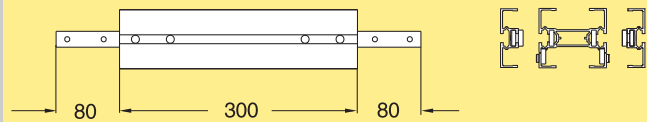

Beam section for chain installation
Including connecting strips and screws

XBCC 300A

Beam accessories XB

Connecting strip with set screws

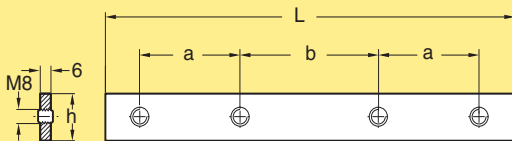

Connecting strip with set screws
h=20, a=44, b=44, L=160

XSCJ 6x160

Note. Must be ordered in multiples of 10

Cover strip for T-slot, aluminium

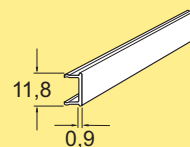

Cover strip for T-slot
Aluminium, anodized
Length 2 m

XCAC 2

For XK-XB

Cover strip for T-slot, PVC

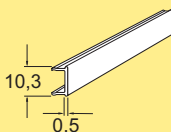

Cover strip for T-slot, grey PVC
Length 3 m

XCAC 3 P

For XK-XB

Slide rails XB

Plastic slide rail for XB beam

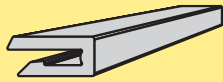

Slide rail

Length 25 m
HDPE (Black)
PA-PE (Grey)

XBCR 25
XBCR 25 H

See Appendix A, page 351 for selection guidelines and assembly instructions.

Plastic slide rail for XB beam, outer

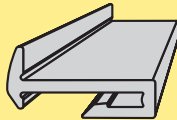

Slide rail, outer

UHMW-PE ($\mu=0,1-0,25$) (Grey)
Length 3 m

XBCR 3 UA

See Appendix A, page 351 for selection guidelines and assembly instructions.

Mounting tool for slide rail, XB

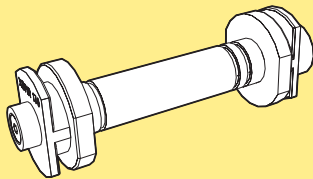

Mounting tool for slide rail

XBMR 170

Aluminium rivets

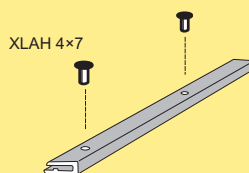

Aluminium rivets 4 mm for XK-XB conveyors, brown

XLAH 4x7

Extra slide rail in plain bends must be anchored using plastic screws due to lack of space for the rivet crimping tool.
Note. Must be ordered in multiples of 250.

Plastic screws for slide rail

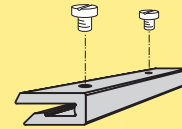

Plastic screws 5 mm for XS-XL-X85-XH-XB beams

XLAG 5

Note. Must be ordered in multiples of 50

Drill fixture for slide rail

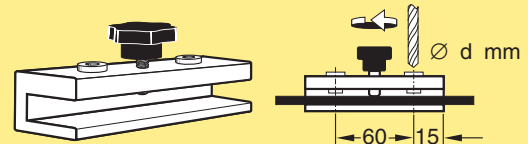

Drill fixture for XL-X85-XH-XK-XB slide rail

d=4,2 mm

3920500

Rivet crimping pliers



Rivet crimping pliers for XL-X85-XH-XK-XB

For 4 mm rivets

5051395

Rivet crimping clamp

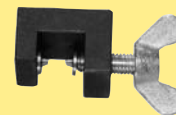

Rivet crimping clamp for XL-X85-XH-XK-XB

For 4 mm rivets

3923005

End drive units XB 175, direct drive, no slip clutch

End drive unit LP/LAP for 175 mm chain

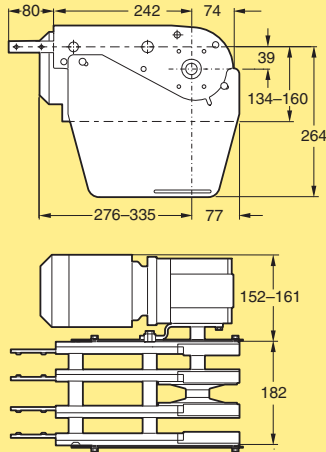

End drive unit, direct drive
3-phase motor on left side
50 Hz 230/400 V
60 Hz 230/460 V

XBEB #A175 LP
XBEB #A175 LAP

Insert desired speed instead of # in designation:
50 Hz: 5-10-15-20-25-30-40-50-60 m/min.
60 Hz: 6-10-16-19-31-36-44-63 m/min.
Maximum traction force: 1250 N. See page 16.
Effective track length: 0,80 m
Variable speed motors: see page 347.

End drive unit RP/RAP for 175 mm chain

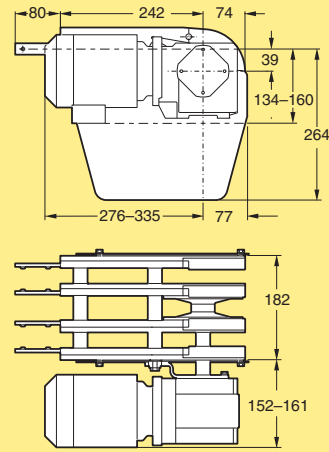

End drive unit, direct drive
3-phase motor on right side
50 Hz 230/400 V
60 Hz 230/460 V

XBEB #A175 RP
XBEB #A175
RAP

Insert desired speed instead of # in designation:
50 Hz: 5-10-15-20-25-30-40-50-60 m/min.
60 Hz: 6-10-16-19-31-36-44-63 m/min.
Maximum traction force: 1250 N. See page 16.
Effective track length: 0,80 m
Variable speed motors: see page 347.

End drive units XB 175, direct drive, slip clutch

End drive unit LPB/LAPB for 175 mm chain

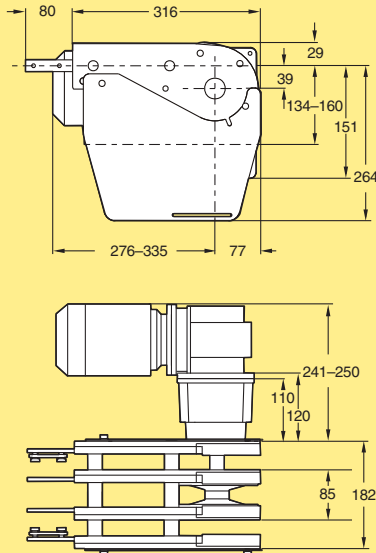

End drive unit, direct drive
3-phase motor on left side
50 Hz 230/400 V
60 Hz 230/460 V

XBEB #A175 LPB
XBEB #A175 LAPB

Insert desired speed instead of # in designation:
50 Hz: 5-10-15-20-25-30-40-50-60 m/min.
60 Hz: 6-10-16-19-31-36-44-63 m/min.
Maximum traction force: 1250 N. See page 16.
Effective track length: 0,80 m
Variable speed motors: see page 347.

End drive unit RPB/RAPB for 175 mm chain

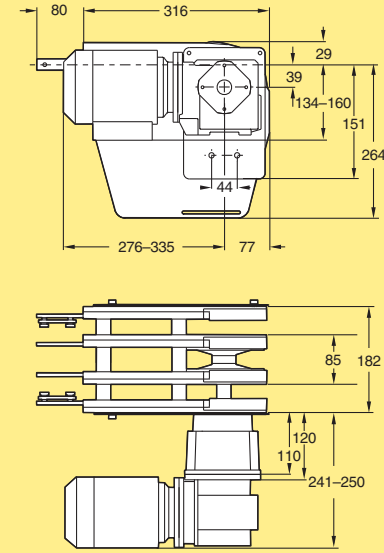

End drive unit, direct drive
3-phase motor on right side
50 Hz 230/400 V
60 Hz 230/460 V

XBEB #A175 RPB
XBEB #A175
RAPB

Insert desired speed instead of # in designation:
50 Hz: 5-10-15-20-25-30-40-50-60 m/min.
60 Hz: 6-10-16-19-31-36-44-63 m/min.
Maximum traction force: 1250 N. See page 16.
Effective track length: 0,80 m
Variable speed motors: see page 347.

End drive units XB 295, direct drive, no slip clutch

End drive unit LP/LAP for 295 mm chain

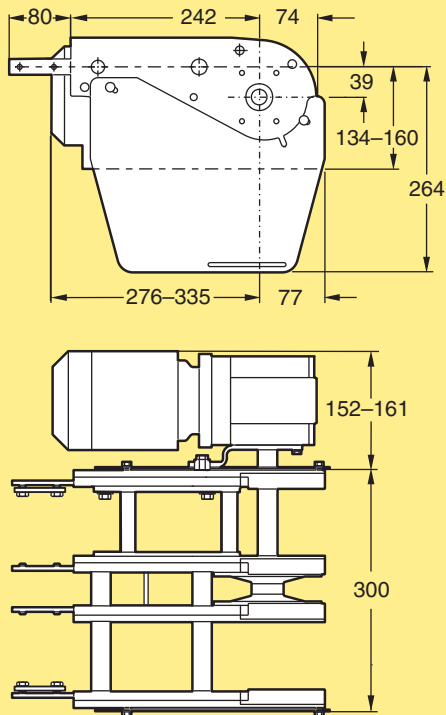

End drive unit, direct drive
 3-phase motor on left side
 50 Hz 230/400 V
 60 Hz 230/460 V

XBEB #A295 LP
XBEB #A295 LAP

Insert desired speed instead of # in designation:
 50 Hz: 5-10-15-20-25-30-40-50-60 m/min.
 60 Hz: 6-10-16-19-31-36-44-63 m/min.
 Maximum traction force: 1250 N. See page 16.
 Effective track length: 0,80 m
 Variable speed motors: see page 347.

End drive unit RP/RAP for 295 mm chain

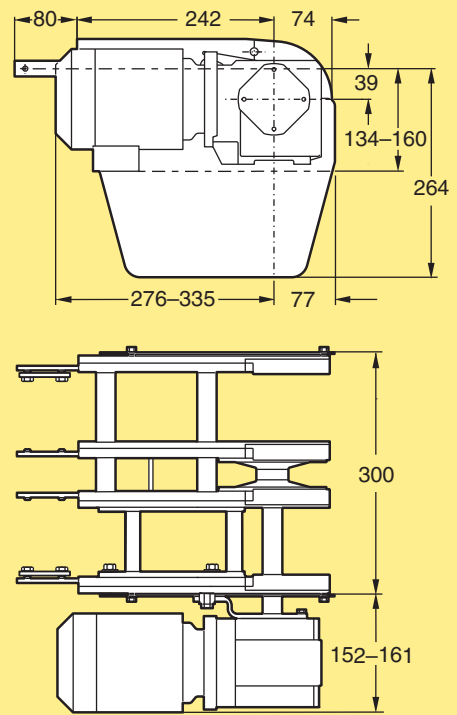

End drive unit, direct drive
 3-phase motor on right side
 50 Hz 230/400 V
 60 Hz 230/460 V

XBEB #A295 RP
XBEB #A295 RAP

Insert desired speed instead of # in designation:
 50 Hz: 5-10-15-20-25-30-40-50-60 m/min.
 60 Hz: 6-10-16-19-31-36-44-63 m/min.
 Maximum traction force: 1250 N. See page 16.
 Effective track length: 0,80 m
 Variable speed motors: see page 347.

PO
 XS
 XL
 XLP
 X85
 X85P
 XH
 XK
 XKP
XB
 GR
 CS
 XT
 XC
 XF
 FST
 XMY
 XLX
 XMX
 GRX
 CSX
 ELV
 CTL
 TR
 APX
 IDX

End drive units XB 295, direct drive, slip clutch

End drive unit LPB/LAPB for 295 mm chain

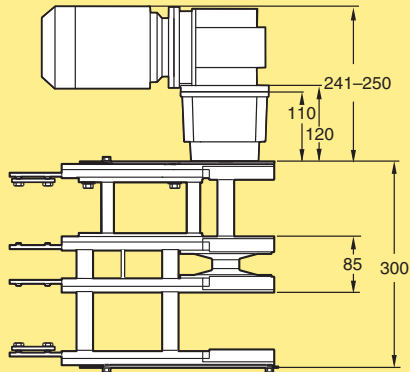
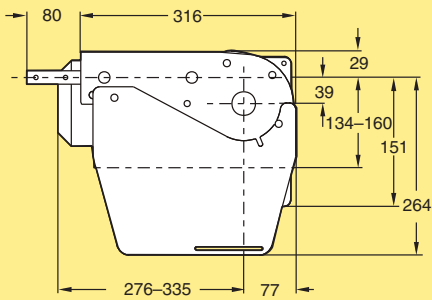

End drive unit, direct drive
3-phase motor on left side
50 Hz 230/400 V
60 Hz 230/460 V

XBEB #A295 LPB
XBEB #A295 LAPB

Insert desired speed instead of # in designation:
50 Hz: 5-10-15-20-25-30-40-50-60 m/min.
60 Hz: 6-10-16-19-31-36-44-63 m/min.
Maximum traction force: 1250 N. See page 16.
Effective track length: 0,80 m
Variable speed motors: see page 347.

End drive unit RPB/RAPB for 295 mm chain

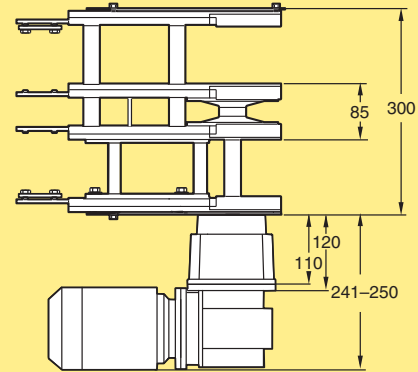
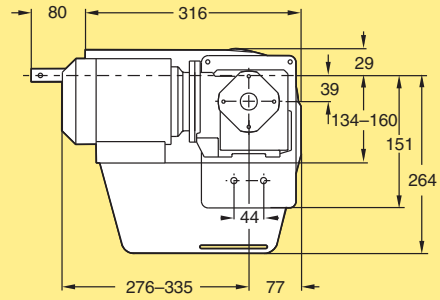

End drive unit, direct drive
3-phase motor on right side
50 Hz 230/400 V
60 Hz 230/460 V

XBEB #A295 RPB
XBEB #A295 RAPB

Insert desired speed instead of # in designation:
50 Hz: 5-10-15-20-25-30-40-50-60 m/min.
60 Hz: 6-10-16-19-31-36-44-63 m/min.
Maximum traction force: 1250 N. See page 16.
Effective track length: 0,80 m
Variable speed motors: see page 347.

Idlers XB 175

Idler end unit for 175 mm chain

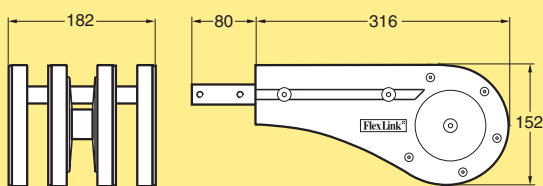

Idler end unit

XBEJ A175

Effective track length: 0,80 m

Protective cover for idler end unit

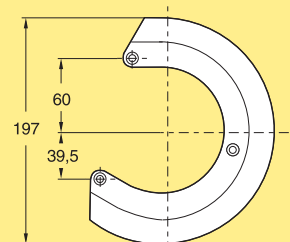

Protective cover for idler end unit

XBSJ 197A175

Idlers XB 295

Idler end unit for 295 mm chain

Idler end unit **XBEJ A295**
 Effective track length: 0,80 m

Horizontal plain bends XB 175

Horizontal plain bend, 30° for 175 mm chain

Horizontal plain bend, 30°±1°
 R=500±10 mm **XBBP 30A175R5**
 R=700±10 mm **XBBP 30A175R7**
 R=1000±10 mm **XBBP 30A175R10**

Effective track lengths:
 R500: 1,35 m (top+bottom)
 R700: 1,55 m (top+bottom)
 R1000: 1,85 m (top+bottom)

Horizontal plain bend, 45° for 175 mm chain

Horizontal plain bend, 45°±1°
 R=500±10 mm **XBBP 45A175R5**
 R=700±10 mm **XBBP 45A175R7**
 R=1000±10 mm **XBBP 45A175R10**

Effective track lengths:
 R500: 1,60 m (top+bottom)
 R700: 1,90 m (top+bottom)
 R1000: 2,40 m (top+bottom)

PO
 XS
 XL
 XLP
 X85
 X85P
 XH
 XK
 XKP
XB
 GR
 CS
 XT
 XC
 XF
 FST
 XMY
 XLX
 XMX
 GRX
 CSX
 ELV
 CTL
 TR
 APX
 IDX

Horizontal plain bends XB 175 (continued)

Horizontal plain bend, 60° for 175 mm chain

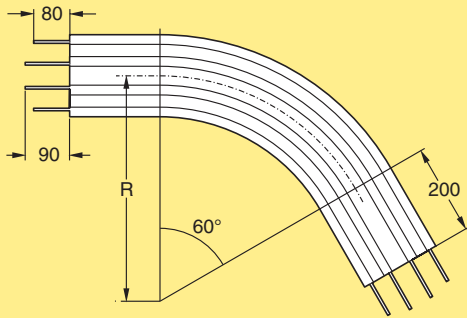

Horizontal plain bend, $60^\circ \pm 1^\circ$

R=500±10 mm

R=700±10 mm

R=1000±10 mm

XBBP 60A175R5
XBBP 60A175R7
XBBP 60A175R10

Effective track lengths:

R500: 1,85 m (top+bottom)

R700: 2,30 m (top+bottom)

R1000: 2,90 m (top+bottom)

Horizontal plain bend, 90° for 175 mm chain

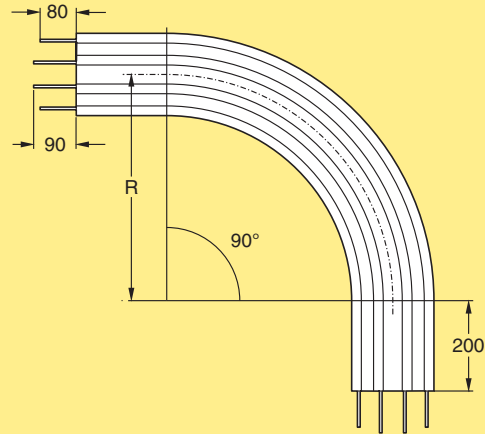

Horizontal plain bend, $90^\circ \pm 1^\circ$

R=500±10 mm

R=700±10 mm

R=1000±10 mm

XBBP 90A175R5
XBBP 90A175R7
XBBP 90A175R10

Effective track lengths:

R500: 2,40 m (top+bottom)

R700: 3,00 m (top+bottom)

R1000: 3,95 m (top+bottom)

Horizontal plain bends XB 295

Horizontal plain bend, 30° for 295 mm chain

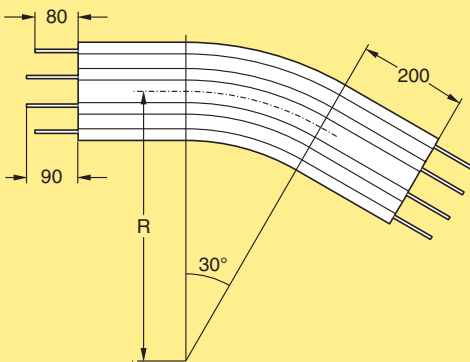

Horizontal plain bend, $30^\circ \pm 1^\circ$

R=700±10 mm

R=1000±10 mm

XBBP 30A295R7
XBBP 30A295R10

Effective track lengths:

R700: 1,55 m (top+bottom)

R1000: 1,85 m (top+bottom)

Horizontal plain bend, 45° for 295 mm chain

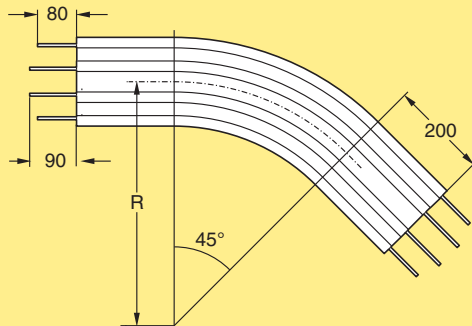

Horizontal plain bend, $45^\circ \pm 1^\circ$

R=700±10 mm

R=1000±10 mm

XBBP 45A295R7
XBBP 45A295R10

Effective track lengths:

R700: 1,90 m (top+bottom)

R1000: 2,40 m (top+bottom)

Horizontal plain bends XB 295 (continued)

Horizontal plain bend, 60° for 295 mm chain

Horizontal plain bend, 60°±1°
 R=700±10 mm
 R=1000±10 mm

XBBP 60A295R7
XBBP 60A295R10

Effective track lengths:
 R700: 2,30 m (top+bottom)
 R1000: 2,90 m (top+bottom)

Horizontal plain bend, 90° for 295 mm chain

Horizontal plain bend, 90°±1°
 R=700±10 mm
 R=1000±10 mm

XBBP 90A295R7
XBBP 90A295R10

Effective track lengths:
 R700: 3,00 m (top+bottom)
 R1000: 3,95 m (top+bottom)

Vertical bends XB 175/295

Vertical bend, 5° for 175/295 mm chain

Vertical bend, 5°

XBBV 5AR750

*Four outer section beam pieces, unassembled. Will fit both chain widths (175 mm and 295 mm).
 Effective track length: 0,50 m (top+bottom)*

Vertical bend, 15° for 175/295 mm chain

Vertical bend, 15°

XBBV 15AR750

*Four outer section beam pieces, unassembled. Will fit both chain widths (175 mm and 295 mm).
 Effective track length: 0,75 m (top+bottom)*

