

Vertical bends

Type XS, XL, XM, XH, XK, XB

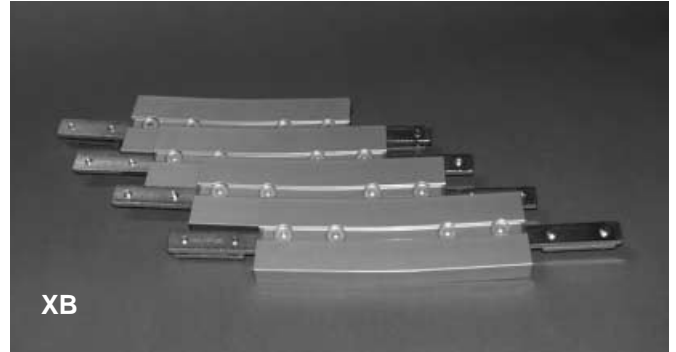
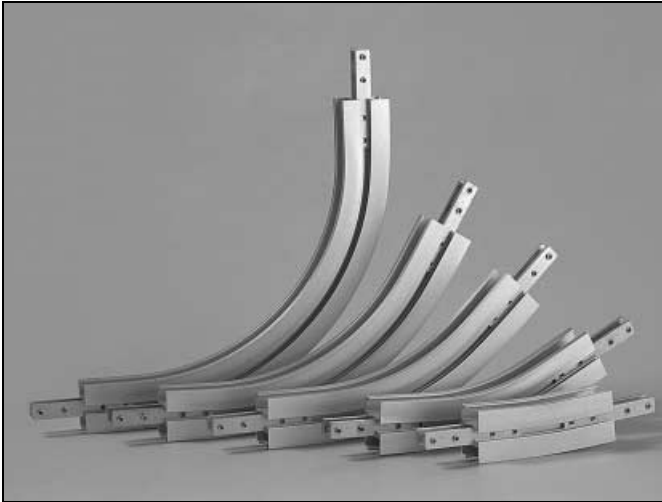

Vertical bends XB

XB vertical bends are available for 5° and 15° change of direction. They consist of four separate outer section beam pieces. The conveyor bend is created by using the outer section beam pieces to connect two straight conveyor sections. The bend pieces need not be interconnected.

Introduction

Vertical bends can be used either as convex or concave bends. They are available in fixed angles from 5° up to 90° change of direction (XB: 5° and 15°), and in customer specified angles from 5° up to 90°.

For conveyors with an incline exceeding 5°, cleated chain is recommended (not available for XB). Otherwise, the product might slip back on the chain. Friction top chain is an alternative solution which can be used in inclines up to 30°.

For information on the types of chain and cleat available, see "Conveyor chains".

Important

Vertical bends increase the tension in the chain and cause higher stress on the slide rail. Avoid using more than four 90° vertical bends in one conveyor.

To ensure a reliable conveyor design with vertical bends, always consult your FlexLink Systems representative for technical data and design assistance.

Ordering information

- Connecting strips are included.
- XB: Each bend is delivered unassembled. Note that the same XB bends fit both chain width versions.
- For customer specified versions, the angle "E" must be specified.

Vertical bends – overview

Product	XS	XL	XM	XH	XK	XB
Chain width	44 mm	63 mm	83 mm	103 mm	102 mm	175/295 mm
Vertical bends	XSBV *R300 *5/30/45/60/90/E Page 114	XLBV *R300 *5/7/15/30/45/50/60/90/E XLBV *R1000 *7/30/45/90 XLBV *R1225 *30/45 Page 115	XMBV *R400 *5/7/15/30/45/60/90/E XMBV *R1000 *45/90 Page 116	XHBV *R400 *5/7/15/30/45/60/90/E XHBV *R1000 *45/90 Page 118	XKBV *R750 *5/15/30/45/60/90/E Page 119	XBBV *AR750 *5/15 Page 120

Vertical bends XS

Vertical bend, 5° XS

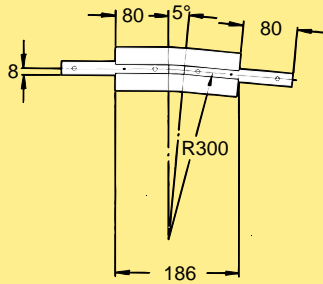

Vertical bend, 5° **XSBV 5R300**
 Effective track length: 0,20 m 1-way (0,40 m 2-way)

Vertical bend, 60° XS

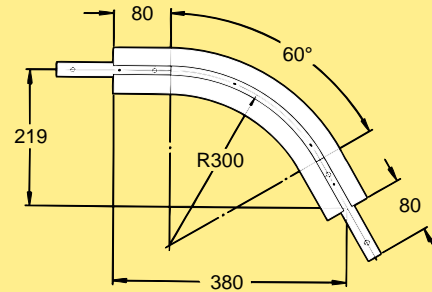

Vertical bend, 60° **XSBV 60R300**
 Effective track length: 0,50 m 1-way (0,95 m 2-way)

Vertical bend, 30° XS

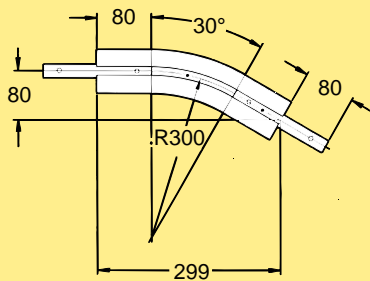

Vertical bend, 30° **XSBV 30R300**
 Effective track length: 0,35 m 1-way (0,65 m 2-way)

Vertical bend 90° XS

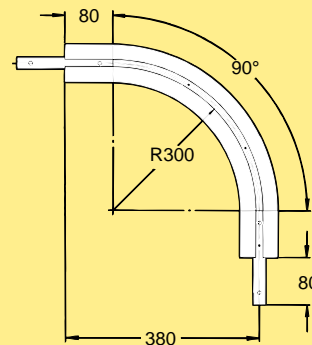

Vertical bend, 90° **XSBV 90R300**
 Effective track length: 0,70 m 1-way (1,30 m 2-way)

Vertical bend, 45° XS

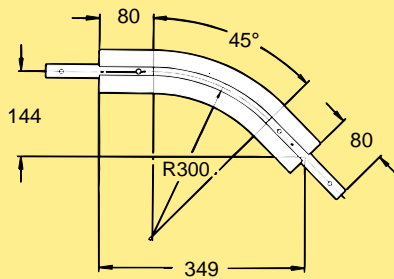

Vertical bend, 45° **XSBV 45R300**
 Effective track length: 0,45 m 1-way (0,80 m 2-way)

Vertical bend, 5°-90° XS

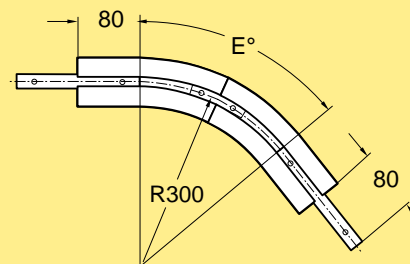

Vertical bend, 5°-90° **XSBV ER300**
 The bend is cut in the middle to the desired angle and assembled using connecting strips. The angle "E" must be specified when ordering.

Vertical bends XL

Vertical bend, 5° **XL**

Vertical bend, 5° **XLBV 5R300**
 Effective track length: 0,20 m 1-way (0,40 m 2-way)

Vertical bend, 30° **XL**

Vertical bend, 30°
 R= 300, A=299, B= 80 **XLBV 30R300**
 R=1000, A=649, B=174 **XLBV 30R1000**
 R=1225, A=762, B=204 **XLBV 30R1225**

Vertical bend, 7° **XL**

Vertical bend, 7° **XLBV 7R300**
 R= 300, A=196, B=12 **XLBV 7R1000**
 R=1000, A=281, B=17

Effective track length:
 R300: 0,20 m 1-way (0,40 m 2-way)
 R1000: 0,30 m 1-way (0,60 m 2-way)

Effective track length:
 R300: 0,35 m 1-way (0,65 m 2-way)
 R1000: 0,70 m 1-way (1,40 m 2-way)
 R1225: 0,85 m 1-way (1,65 m 2-way)

Vertical bend, 45° **XL**

Vertical bend, 45° **XLBV 45R300**
 R= 300, A= 349, B=144 **XLBV 45R1000**
 R=1000, A= 844, B=349 **XLBV 45R1225**
 R=1225, A=1003, B=415

Effective track length:
 R300: 0,45 m 1-way (0,80 m 2-way)
 R1000: 0,95 m 1-way (1,90 m 2-way)
 R1225: 1,15 m 1-way (2,30 m 2-way)

Vertical bend, 15° **XL**

Vertical bend, 15° **XLBV 15R300**
 Effective track length: 0,25 m 1-way (0,50 m 2-way)

Vertical bend, 50° **XL**

Vertical bend, 50° **XLBV 50R1000**
 Effective track length: 1,10 m 1-way (2,15 m 2-way)

Standard conveyor systems

Vertical bends XL (continued)

Vertical bend, 60°

XL

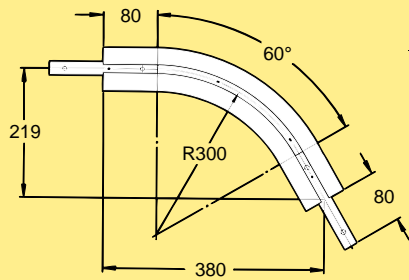

Vertical bend, 60°

XLBV 60R300

Effective track length: 0,50 m 1-way (0,95 m 2-way)

Vertical bend, 5°–90°

XL

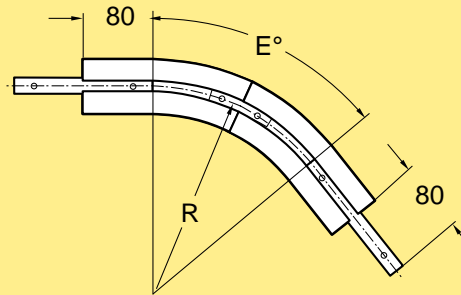

Vertical bend, 5°–90°

R=300
R=1000

XLBV ER300
XLBV ER1000

The bend is cut in the middle to the desired angle and assembled using connecting strips. The angle "E" must be specified when ordering.

Vertical bend, 90°

XL

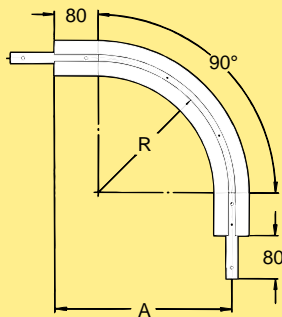

Vertical bend, 90°

R= 300, A= 380
R=1000, A=1080

XLBV 90R300
XLBV 90R1000

Effective track length:

R300: 0,70 m 1-way (1,30 m 2-way)

R1000: 1,75 m 1-way (3,50 m 2-way)

Vertical bends XM

Vertical bend, 5°

XM

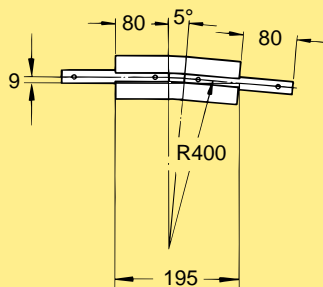

Vertical bend, 5°

XMBV 5R400

Effective track length: 0,20 m 1-way (0,40 m 2-way)

Vertical bend, 7°

XM

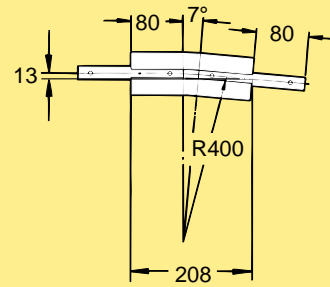

Vertical bend, 7°

XMBV 7R400

Effective track length: 0,20 m 1-way (0,45 m 2-way)

Vertical bend, 15° XM

Vertical bend, 15° **XMBV 15R400**
 Effective track length: 0,30 m 1-way (0,55 m 2-way)

Vertical bend, 60° XM

Vertical bend, 60° **XMBV 60R400**
 Effective track length: 0,65 m 1-way (1,20 m 2-way)

Vertical bend, 30° XM

Vertical bend, 30° **XMBV 30R400**
 Effective track length: 0,40 m 1-way (0,75 m 2-way)

Vertical bend, 90° XM

Vertical bend, 90° **XMBV 90R400**
XMBV 90R1000
 R= 400, A= 480
 R=1000, A=1080
 Effective track length:
 R400: 0,85 m 1-way (1,60 m 2-way)
 R1000: 1,75 m 1-way (3,50 m 2-way)

Vertical bend, 45° XM

Vertical bend, 45° **XMBV 45R400**
XMBV 45R1000
 R= 400, A=419, B=417
 R=1000, A=844, B=349
 Effective track length:
 R400: 0,50 m 1-way (0,95 m 2-way)
 R1000: 0,95 m 1-way (1,90 m 2-way)

Vertical bend, 5°–90° XM

Vertical bend, 5°–90° **XMBV ER400**
XMBV ER1000
 R=400
 R=1000
 The bend is cut in the middle to the desired angle and assembled using connecting strips. The angle "E" must be specified when ordering.

Standard conveyor systems

Vertical bends XH

Vertical bend, 5° XH

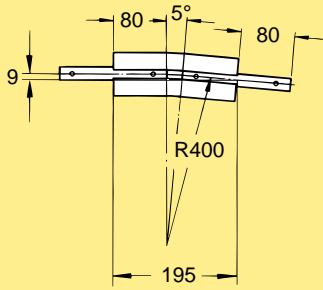

Vertical bend, 5° **XHBV 5R400**
 Effective track length: 0,20 m 1-way (0,40 m 2-way)

Vertical bend, 30° XH

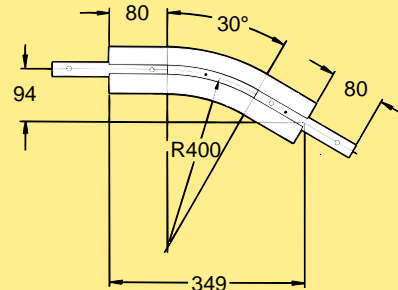

Vertical bend, 30° **XHBV 30R400**
 Effective track length: 0,40 m 1-way (0,75 m 2-way)

Vertical bend, 7° XH

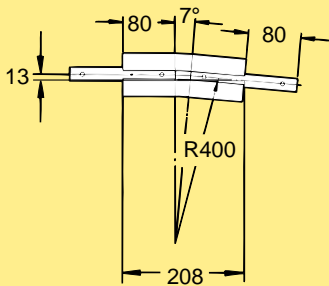

Vertical bend, 7° **XHBV 7R400**
 Effective track length: 0,20 m 1-way (0,45 m 2-way)

Vertical bend, 45° XH

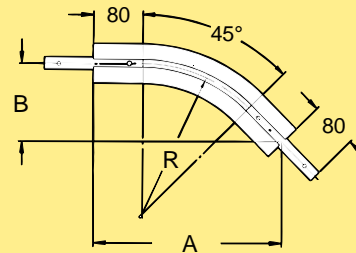

Vertical bend, 45°
 R= 400, A=419, B=174 **XHBV 45R400**
 R=1000, A=844, B=349 **XHBV 45R1000**

Effective track length:
 R400: 0,50 m 1-way (0,95 m 2-way)
 R1000: 0,95 m 1-way (1,90 m 2-way)

Vertical bend, 15° XH

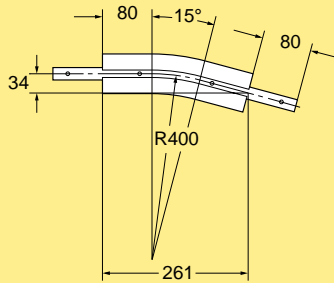

Vertical bend, 15° **XHBV 15R400**
 Effective track length: 0,30 m 1-way (0,55 m 2-way)

Vertical bend, 60° XH

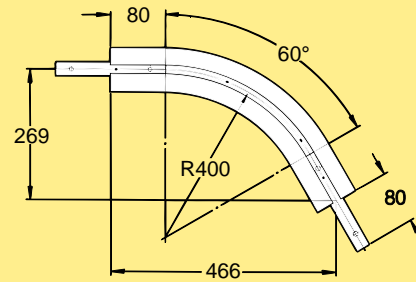

Vertical bend, 60° **XHBV 60R400**
 Effective track length: 0,65 m 1-way (1,20 m 2-way)

Vertical bends XH (continued)

Vertical bend, 90° **XH**

Vertical bend, 90°
 R= 400, A= 480
 R=1000, A=1080

XHBV 90R400
XHBV 90R1000

Effective track length:
 R400: 0,85 m 1-way (1,60 m 2-way)
 R1000: 1,75 m 1-way (3,50 m 2-way)

Vertical bend, 5°–90° **XH**

Vertical bend, 5°–90°
 R=400
 R=1000

XHBV ER400
XHBV ER1000

The bend is cut in the middle to the desired angle and assembled using connecting strips. The angle "E" must be specified when ordering.

Vertical bends XK

Vertical bend, 5° **XK**

Vertical bend, 5°

XKBV 5R750

Effective track length: 0,25 m 1-way (0,50 m 2-way)

Vertical bend, 30° **XK**

Vertical bend, 30°

XKBV 30R750

Effective track length: 0,60 m 1-way (1,15 m 2-way)

Vertical bend, 15° **XK**

Vertical bend, 15°

XKBV 15R750

Effective track length: 0,40 m 1-way (0,75 m 2-way)

Vertical bend, 45° **XK**

Vertical bend, 45°

XKBV 45R750

Effective track length: 0,80 m 1-way (1,55 m 2-way)

Standard conveyor systems

Vertical bends XK (continued)

Vertical bend, 60°

XK

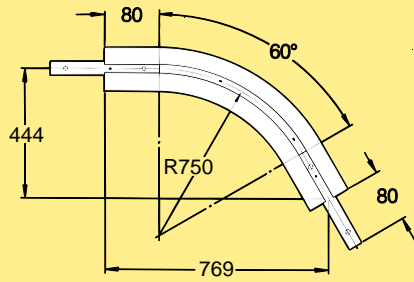

Vertical bend, 60°

XKBV 60R750

Effective track length: 1,00 m 1-way (1,95 m 2-way)

Vertical bend, 5°–90°

XK

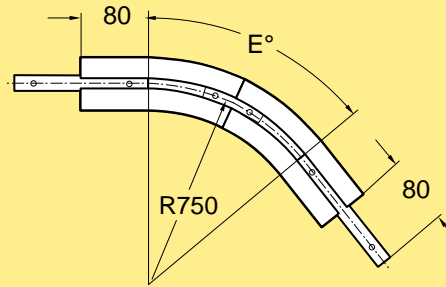

Vertical bend, 5°–90°

XKBV ER750

The bend is cut in the middle to the desired angle and assembled using connecting strips. The angle "E" must be specified when ordering.

Vertical bend, 90°

XK

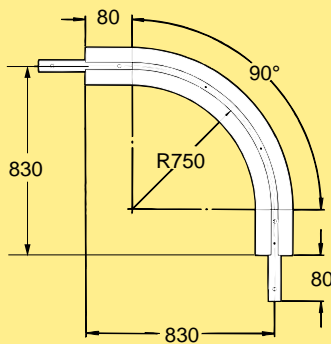

Vertical bend, 90°

XKBV 90R750

Effective track length: 1,40 m 1-way (2,70 m 2-way)

Vertical bends XB (for 175 mm and 295 mm chain)

Vertical bend, 5°

XB

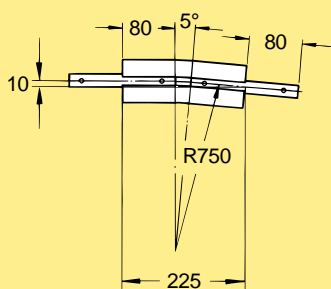

Vertical bend, 5°

XBBV 5AR750

Four outer section beam pieces, unassembled
Effective track length: 0,25 m 1-way (0,50 m 2-way)

Vertical bend, 15°

XB

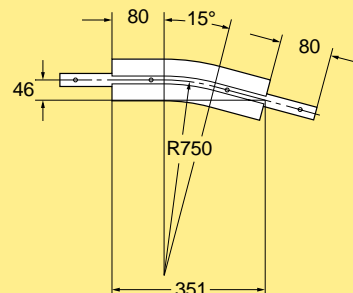

Vertical bend, 15°

XBBV 15AR750

Four outer section beam pieces, unassembled
Effective track length: 0,40 m 1-way (0,75 m 2-way)