

# Stainless steel conveyor system XLX

## Contents

System information.....	21	Idler end unit XLX.....	25
Chains XLX.....	22	Wheel bends XLX.....	26
Chain accessories XLX.....	23	Plain bends XLX.....	27
Beams XLX.....	23	Vertical bends XLX.....	27
Beam accessories XLX.....	23		
Slide rails XLX.....	24		
End drive units XLX.....	25		

## System information



### Chain width 63 mm



### Features

- Wide range of wet applications
- Wedge conveyors
- High speed solutions
- Many chain types available from the standard XL range

### Examples of application areas

Filling lines within the food, personal products and liquid pharmaceuticals segments.

### Technical characteristics

Drive unit capacity	500 N
Chain tension limit	500 N
Beam width	65 mm
Chain width	63 mm
Item width	15–140 mm
Maximum item weight	
Horizontal transport	10 kg
Vertical transport	2 kg
Maximum weight on conveyer	150 kg
Maximum conveyer length	40 m

## Plain chain

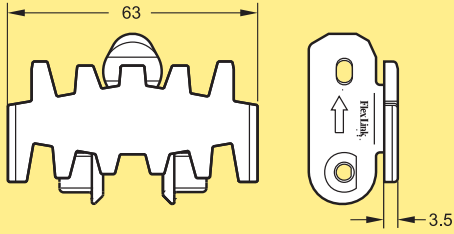

Plain chain  
Length 5 m

**XLTP 5**

Plain link kit \*

**5056085**

Plain chain (Ultra low wear)  
Length 5 m

**XLTP 5 C**

Plain link kit (Ultra low wear)

**n.a.**

\* Link kit contains 10 links, 10 pivots, 10 steel pins

## Friction top chain

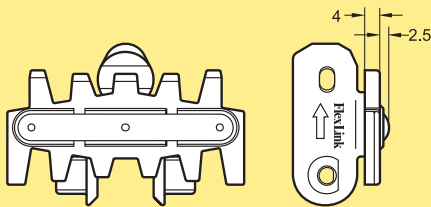

Friction top chain  
Length 5 m

**XLTP 5 FP**

Use the online configurator to specify and order.

Friction top chain, Length 5 m

**XLTP 5 F**

Friction top link kit \*

**5056081**

\* Link kit contains 10 links, 10 pivots, 10 steel pins

## Flat top friction chain

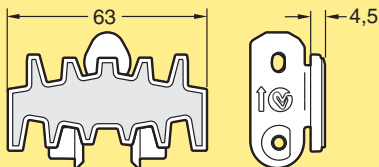

Flat top friction chain  
Length 5 m

**XLTP 5 FA**

Flat top friction kit \*

**5057606**

\* Link kit contains 10 links, 10 pivots, 10 steel pins

## Flexible cleat chain, Type C

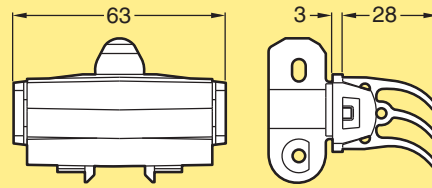

Flexible cleat chain Type C  
Length 5 m

**XLTE 5 C**

Flexible cleat link kit \*

**5055601**

Flexible cleat top kit \*\*

**5056589**

Flexible cleat top kit \*\*\*

**5056558**

\* 10 complete links+pivots+pins

\*\* 10 base links XLTE 63 D+pivots+pins

\*\*\* 10 cleat tops XLTX 55 C

## Flexible cleat chain, Type D

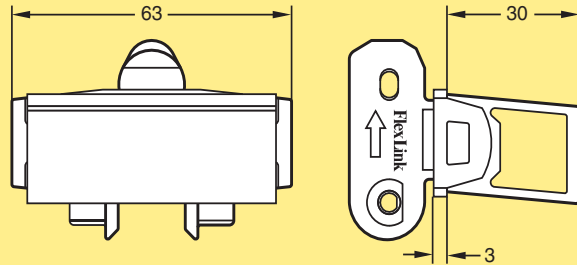

Flexible cleat chain Type D  
Length 5 m

**XLTE 5 D**

Flexible cleat link kit \*

**5056589**

Flexible cleat top kit \*\*

**5058089**

\* 10 base links XLTE 63 D+pivots+pins.

\*\* 10 cleat tops XLTX 55 D

## Chain accessories XLX

### Plastic pivot



Plastic pivot XS, XL

**5111489**

*Plastic pivot kit contains 25 items*

### Steel pin

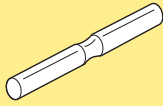

Steel pin XS, XL

**5111492**

*Steel pin kit contains 25 items*

### Pin insertion tool for chain

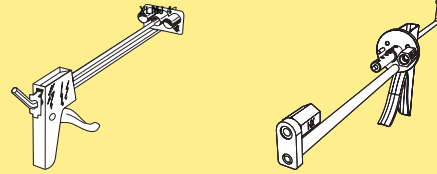

Pin insertion tool

XS-XL-XT

XS-XL-XT, PRO version\*

**XLMJ 4**

**XLMJ 4 P**

*\*This product is recommended for frequent users.*

## Beams XLX

### Conveyor beam

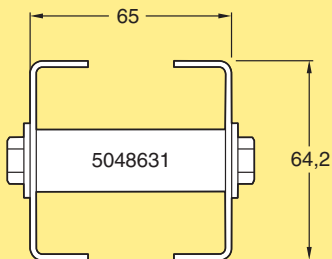

Beam

Length 3 m

Length to order (0,2–3,0 m)

**XLCBX 3**

**XLCBX L**

### Beam section for chain installation

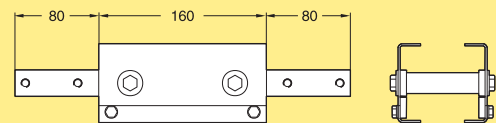

Beam section for chain installation

**XLCCX 160**

*Including connecting strips*

*Screws and nuts for the connecting strips are not included*

## Beam accessories XLX

### Connecting strip

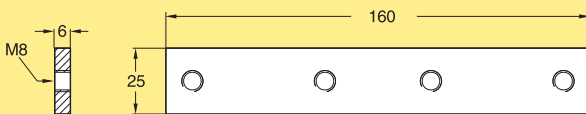

Connecting strip

**XLCJX 6x160**

*Mounting: M6S 8x12 A4 (4), BRB 8,4x24 A4 (4)*

*Screws and nuts are not included*

# Slide rails XLX

## Plastic slide rail for XL, X85, XH beam

XLCR 25 P/H



XLCR 25 U



### Slide rail

Length 25 m

Polyethylene (PE) (Grey)

PVDF (Natural white)

UHMW-PE (White)

PA-PE (Grey)

**XLCR 25**  
**XLCR 25 P**  
**XLCR 25 U**  
**XLCR 25 H**

Installation of slide rails

## Drill fixture for slide rail

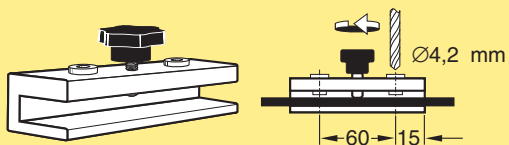

Drill fixture for slide rail

**3920500**

## Plastic screw for slide rail

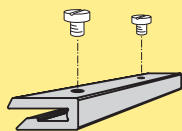

Plastic screw 5 mm for XL-X85-XH

**XLAG 5**

Note. Must be ordered in multiples of 50

## Stainless steel rivet

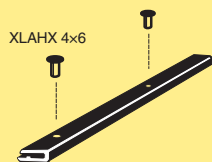

Stainless steel rivet, 4 mm

**XLAHX 4x6**

Note. Must be ordered in multiples of 100

## Rivet crimping pliers for XL-X85-XH



Rivet crimping pliers  
For 4 mm rivets

**5051395**

## Rivet crimping clamp for XL-X85-XH

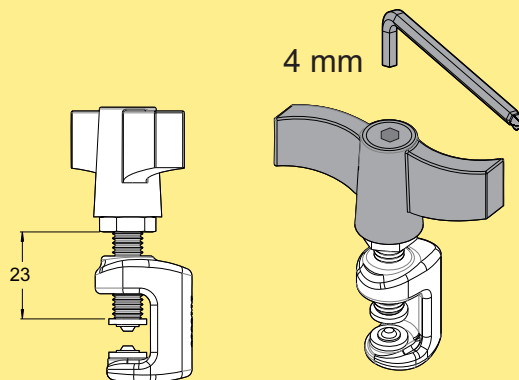

Rivet crimping clamp

For 4 mm rivets

(note: Allen key not included)

**3923005**

## Mounting tool for slide rail

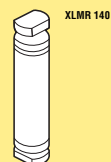

Mounting tool XL

**XLMR 140**

# End drive units XLX

**End drive unit**

End drive unit  
Transmission on left side  
Fixed/variable speed \*  
Without motor

**XLEBX**  
**XLEBX 0 HLP**

Effective track length: 0,80 m  
\* Use online configurator when ordering.

**End drive unit**

End drive unit  
Transmission on right side  
Fixed/variable speed \*  
Without motor

**XLEBX**  
**XLEBX 0 HRP**

Effective track length: 0,80 m  
\* Use online configurator when ordering.

**Drive unit shaft kit**

Drive unit shaft kit for stainless steel drive units Series X

**5051185**

For SEW SA37 gearbox. Including the necessary mounting hardware

## Idler end unit XLX

**Idler end unit**

Idler end unit

**XLEJX 320**

Effective track length: 0,80 m

PO

XLX

X85X

X180X

X300X

WL  
374X

WL  
526X

WL  
678X

CSX

GRX

FSTX

TR

APX

IDX

# Wheel bends XLX

## Wheel bend, 30°

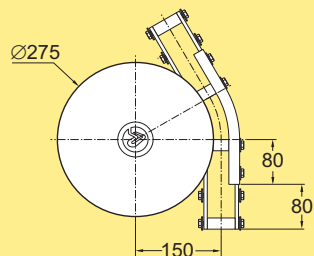

Wheel bend, 30° **XLBHX 30R150**  
Effective track length: 0,25 m (2-way 0,50 m)

## Wheel bend, 90°

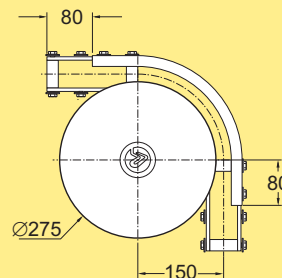

Wheel bend, 90° **XLBHX 90R150**  
Effective track length: 0,40 m (2-way 0,80 m)

## Wheel bend, 45°

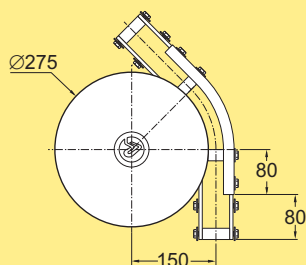

Wheel bend, 45° **XLBHX 45R150**  
Effective track length: 0,30 m (2-way 0,60 m)

## Wheel bend, 180°

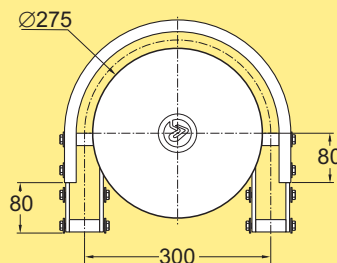

Wheel bend, 180° **XLBHX 180R150**  
Effective track length: 0,65 m (2-way 1,30 m)

## Safety cover for wheel bend XLBHX

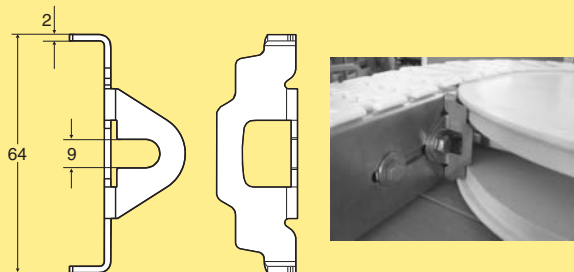

Safety cover for wheel bend XLBHX **5056997**  
Each item consists of two (2) covers 5056925.  
Use the existing screw and washer for assembly.

## Plain bends XLX

### Plain bend, 90°

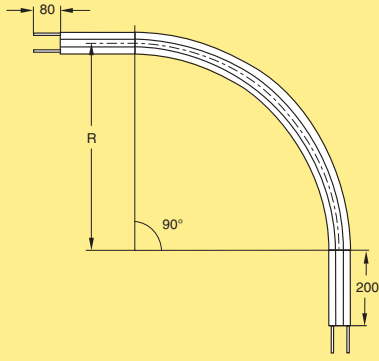

Plain bend, 90°

R=500

R=1000

**XLBPX 90R500**  
**XLBPX 90R1000**

*Effective track lengths:*

*R500: 1,20 m (2-way: 2,40 m)*

*R1000: 2,00 m (2-way: 3,95 m)*

### Note

Other angles and radii are available on request.

## Vertical bends XLX

### Vertical bend 5°

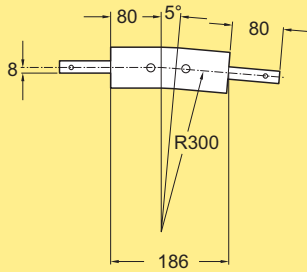

Vertical bend, 5°

**XLBVX 5R300**

*Effective track length: 0,20 m 1-way (0,40 m 2-way)*

### Vertical bend 15°

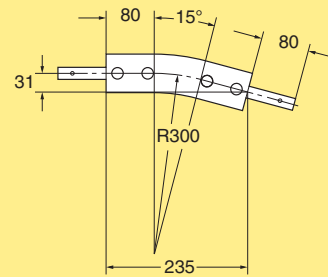

Vertical bend, 15°

**XLBVX 15R300**

*Effective track length: 0,25 m 1-way (0,50 m 2-way)*

### Note

Other angles and radii are available on request.

PO

XLX

X85X

X180X

X300X

WL  
374X

WL  
526X

WL  
678X

CSX

GRX

FSTX

TR

APX

IDX

