

C. Slip clutch adjustment

Introduction

The slip clutch on the drive unit is a safety device which allows the chain to stop if the load becomes excessive. It has two purposes:

- Prevent damage to products on conveyor
- Prevent damage to conveyor

Note

The slip clutch is not a personal safety device. It is primarily intended to protect the equipment.

Where a slip clutch is fitted, it must be adjusted so that it does not slip whenever the drive unit is started under full load. The installation is carried out as follows:

Preparations for adjustment

- 1 Stop the conveyor.
- 2 Ensure that the conveyor cannot be started accidentally. For example: unplug the electric power plug.
- 3 Remove any load on the conveyor.

Caution

If you try to adjust the slip clutch when there is still load on the conveyor, the accumulated tension in the chain can cause severe injuries when you release the clutch.

Adjustment procedure (see Figure 1)

- 1 Remove the drive unit protection cover.
- 2 Use an Allen key, 3 mm, to loosen the screw (1) on the slip clutch so that the adjustment nut (2) can be freely rotated.
- 3 Turn the adjustment nut (2) clockwise with a hook spanner (see Figure 2) until the arrow on the nut is aligned with the desired Fmax value (3). See Table 1 and Table 2 for correct values.

Note: On delivery, the clutch is always set to "0".

- 4 Tighten the screw (1).

Re-install the drive unit protection cover.

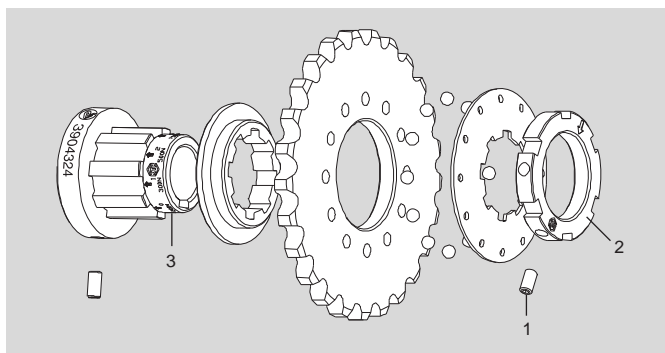

Figure 1. Slip clutch (exploded view)



Figure 2. Hook spanner 5053980

Table 1. Adjustment of slip clutch for End drive units

No.	Traction force, Fmax (N)			
	XS X65	X85/XM, XH, XK, X180/X300	XT	XK H
0	300	300	300	600
1	400	400	400	800
2	500	500	500	1000
3		700	700	1150
4		800	800	1300
5				1550
6		1050	1050	1700
7				
8		1250	1250	2000
9				
10			1400	2200
11				
12			1500	2400
13				
14			1650	2500
Note!	Standard and direct drives 1/2": Slip clutches marked 3904324, 5052769, 3925774, 5052827			Standard drives 5/8": Slip clutches marked 3925071, 5052772

Table 2. Adjustment of slip clutch for Wheel bend drive units

No.	Traction force, Fmax (N)	
	XS, X65	X85/XM, XH, XK
0	150	150
1	200	200
2		
3		
4		
5		
6		
7		
8		
9		
10		
11		
12		
13		
14		
Note!	Standard and direct drives 1/2": Slip clutches marked 3904324, 5052769, 3925774, 5052827	